



All photos © 2006 Mark Harmel

THE TRUST FOR PUBLIC LAND WORKS TO SAVE THE SOUTH CENTRAL FARM.

After a three-year land-use battle that made news around the world, the Trust for Public Land (TPL) has joined forces with the South Central Farmers and secured an opportunity to save the Farm!

To do so, we must raise \$1 million in the next 30 days. And for this, we need your help.

The Trust for Public Land is a national 501(c)3 non-profit organization whose mission is "Conserving land for people," with a long record of success. Together with TPL and the South Central Farmers, you can help preserve the South Central Farm as vital open space in the center of the inner city.

Please contribute today. Your donation is tax deductible. Use the coupon inside. With your help, we can change LA history as we shape LA's future.

To learn more:

Trust for Public Land
3250 Wilshire Blvd, Suite 2003
Los Angeles, CA 90010
www.tpl.org/p4pla
bob.reid@tpl.org
213.380.4233 x14

South Central Farmers
7309 Clybourn Av, Ste 1
Sun Valley, CA 91352
www.southcentralfarmers.com
southcentralfarmers@hotmail.com
818.255.1483 or 909.605.3136

© 2006 South Central Farmers

SOUTH CENTRAL FARMERS AND THE GREENING OF LOS ANGELES

THE LAND WAS BROKEN, SCARRED, PAVED OVER. Wherever you looked, you saw abandoned refrigerators, shards of glass, old tires, piles of rags, discarded furniture. The lot was slated to become a warehouse, to join dozens of other warehouses in the area, a place of repose for the bales of tube socks, oceans of diet soda, and trainloads of novelties we require for our modern quality of life.

And then the city decided it wanted the land for a trash incinerator. It took the land through eminent domain. But the people who lived nearby said no thank you, we breathe enough smoke as it is.

The land waited. Rats became resident. Crimes went unheeded. The Los Angeles Regional Food Bank happened to have its offices across the street, saw this land in limbo and got an idea: what about letting people grow food here?

The city agreed that perhaps the citizens of South Central Los Angeles might benefit from a better use of the land than the dump it had become. And that's where this story begins.

We were invited onto the land. We took away the trash, cut down the weeds, got rid of the rats. We reached into the soil, turned it over, and found that the soil could live again. Soil breathes, soil drinks, soil sweats. Soil harbors life. Soil harbors dreams. When you give to the soil, the soil gives back.

FOR MANY CITY DWELLERS, having neighborhood green space allows for some great hobby gardening. But for us, it means creating our own access to fresh produce. It means maintaining a vibrant community where our families can grow traditional foods. And it means providing a space to spend time with our kids in a gang-free environment.

Right now, this 14-acre farm which we have worked for over 13 years is threatened with demolition. Real estate is always a rough-and-tumble game in Los Angeles, and a byzantine backroom deal has put the title of this once publicly owned land back in the hands of developers who would use it for—a warehouse!

But in our hands, we have something much more powerful. We have the 350 farmers who work this land every day. We have their husbands and wives, brothers and sisters, sons and daughters, cousins and uncles and aunts and nephews and nieces, and all their friends. We have the thousands of city residents who visit the farm regularly, and who buy fresh organic fruits, vegetables, and herbs here. We have the growing tens of thousands of supporters around the world who know our story and are taking up our cause. We have our two resident owls, our resident hawk, and the exploding variety of songbirds which haven't been seen in this part of the city for decades. We know that this time, the better angels of our city will prevail, and this land will not be lost to lifeless pavement again.

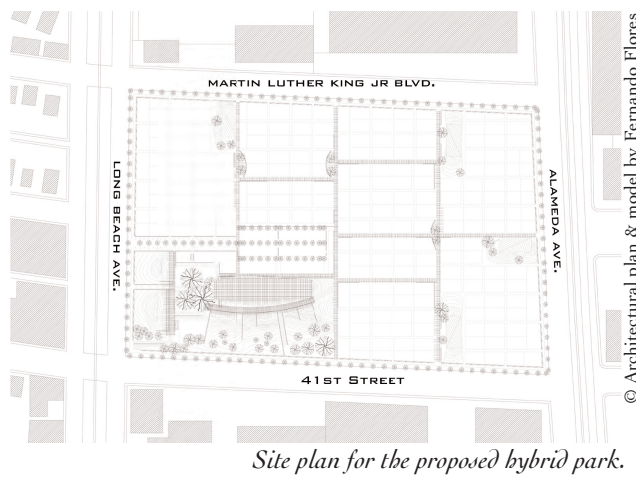

Site plan for the proposed hybrid park.

© Architectural plan & model by Fernando Flores

► **You are probably wondering how.**

We will raise a park here: the hub of a city-wide green movement, a learning center for schoolchildren, a demonstration garden for home gardeners, a community space for art and performance, a plaza for our farmer's market, a commons for all of us. From here, urban community gardens will sprout all over the city, all over the state, all over the Americas.

The plans are on the table. The designs are in the works. The movement is coming together, gathering momentum, building steam. City residents, organizations, and businesses are



Architectural model of proposed learning center.

© 2006 David Fukumoto

joining the fight. The media and the politicians are taking notice. And it's only a matter of time before you will come up against the question for yourself: **which side are you on?**

JOIN US.

We are staying on this land. We will secure the Farm as an oasis of peace, of tradition, of family, of friendship. We will transform these 14 acres into a hybrid park for the whole of Los Angeles, so that all Angelenos can come and learn how to grow a garden, learn how to grow a community, learn how to grow into themselves. Just as we have done.

We are raising money and we are raising a movement. We are going to buy this land for the people. We are going to stop the bulldozers from destroying our 15 years of labor. And we welcome your participation.

Please visit us at www.southcentralfarmers.com, or come by our Farmer's Market: Sundays from 8AM to 5PM at 41st & Long Beach Ave, (1 block west of Alameda) just south of downtown LA.

South Central Farmers
c/o The Trust For Public Land
3250 Wilshire Blvd Suite 2003
Los Angeles, CA 90010

Dear South Central Farmers:

Your work inspires the whole world. Keep up the good fight on behalf of all Angelenos.

Please accept my contribution of:

\$25 \$50 \$100 \$250 \$500 Other

Sincerely,

Please make checks payable to "The Trust for Public Land" and write "South Central Farm" on the memo line of your check. Your donation is tax-deductible.